

WALL TYPES

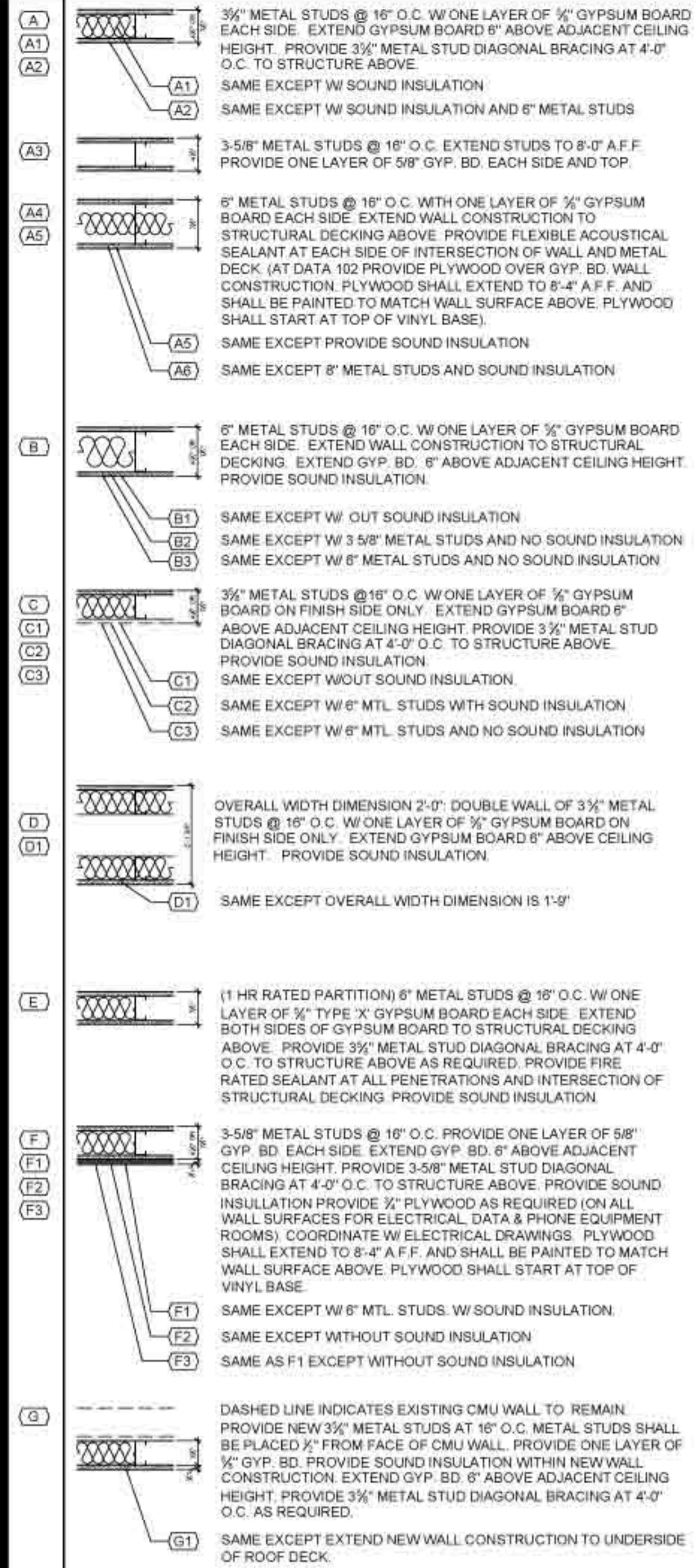

(FEC) FEC: FULLY RECESSED FIRE EXTINGUISHER CABINET AND A COSMIC 100, 10# MULTIPURPOSE DRY CHEMICAL EXTINGUISHER RATED 4A:80B:C. REF. SPECIFICATIONS, MOUNT CABINET SO THAT CENTERLINE OF HANDLE OF DOOR IS 48" A.F.F.

KEY PLAN

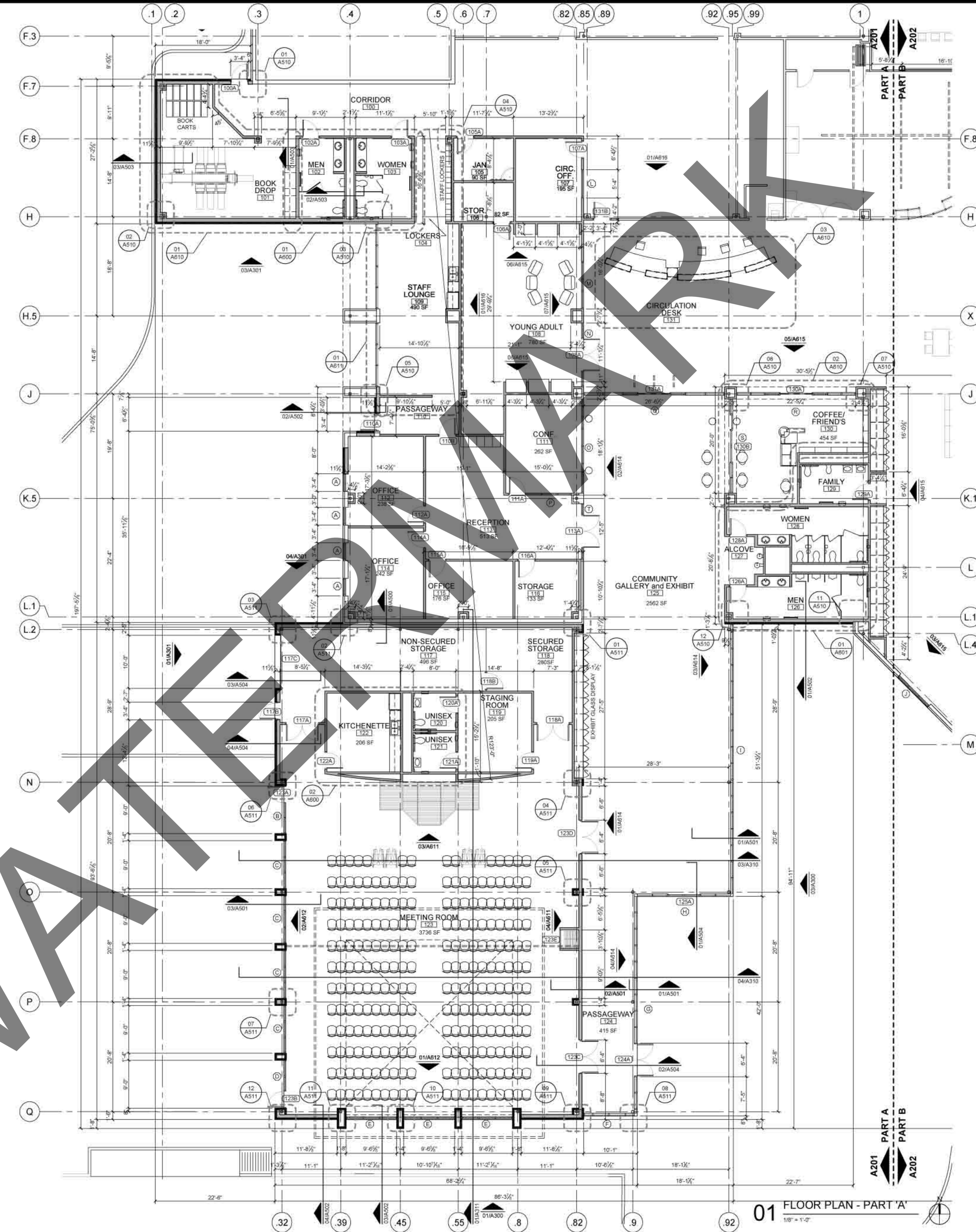

01 FLOOR PLAN - PART 'A'
 1/8" = 1'-0"

JOB NO.	28000
Issue Date:	06/19/2009
Drawn By:	DZ
Checked By:	TB
SHEET NO.	

A201